

## 04Y-479 TYPE 5 MUFFLER SET

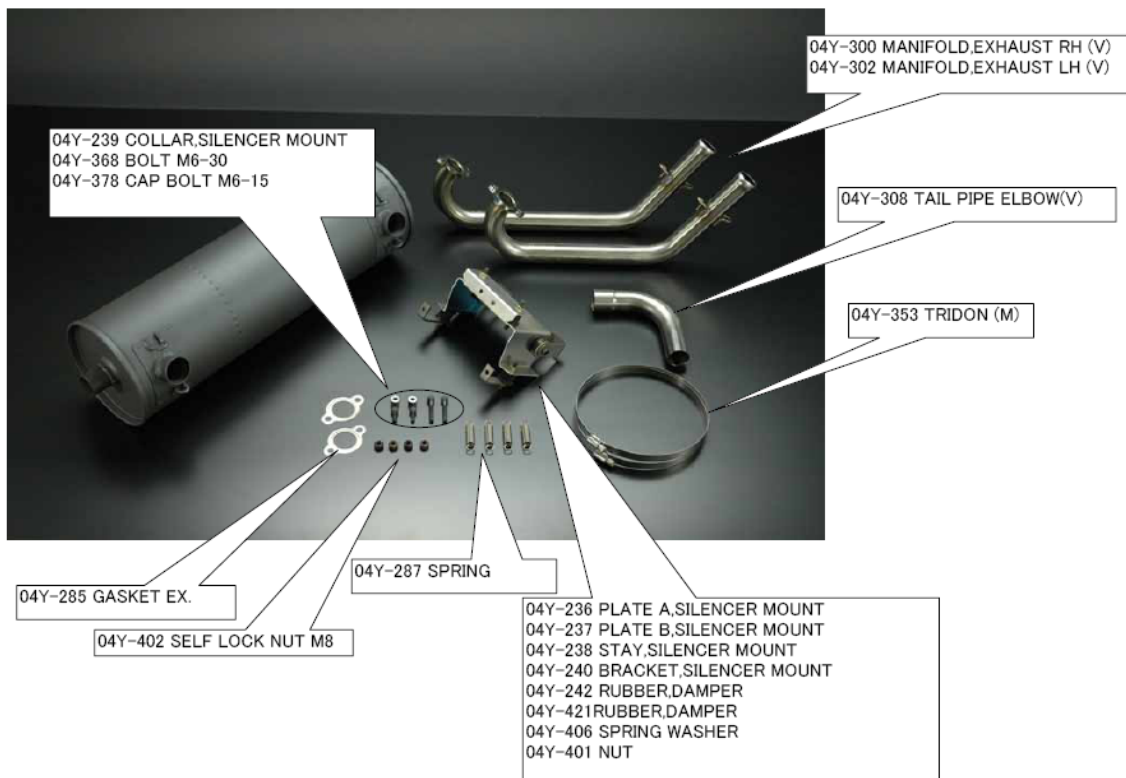

The Type 5 Exhaust kit comes with the following parts:

DESCRIPTION	Part Number	QTY
PLATE A, SILENCER MOUNT	04Y-236	1

PLATE B, SILENCER MOUNT	04Y-237	1
STAY,SILENCER MOUNT "L" bracket	04Y-238	2
COLLAR,SILENCER MOUNT spacer	04Y-239	2
BRACKET,SILENCER MOUNT "U" bracket	04Y-240	2
RUBBER,DAMPER	04Y-242	4
GASKET EX.	04Y-285	2
SPRING (Exhaust Spring)	04Y-287	4
MANIFOLD,EXHAUST RH (V)	04Y-300	1
MANIFOLD,EXHAUST LH (V)	04Y-302	1
MAIN MUFFLER (V) (note the same muffler is used in the Type 4 Muffler)	04Y-306	1
TAIL PIPE ELBOW(V)	04Y-308	1
TRIDON (M) HOSE CLAMP - Stainless steel	04Y-353	2
BOLT M6-30	04Y-368	2
BOLT M6-35	04Y-369	2
CAP BOLT M6-15	04Y-378	2
M6 NUT	04Y-401	10
SELF LOCK NUT M8 (manifold nut)	04Y-402	4
SPRING WASHER (split lock washer)	04Y-406	10
RUBBER,DAMPER	04Y-421	2

**Parts for the Type 5 Exhaust are as follows:**



04Y-236 PLATE A,SILENCER MOUNT (Quantity 1)

Upper larger plate in the picture at the left

04Y-237 PLATE B,SILENCER MOUNT (Quantity 1)

Lower smaller plate in the picture at the left

Note: mounts are covered with a blue plastic film to protect the finish. Blue film can be removed after assembly and installation.



04Y-238 STAY, SILENCER MOUNT "L"  
Bracket (Quantity 2)  
Pictured at the left



04Y-239 COLLAR, SILENCER MOUNT spacer  
(Quantity 2)  
Pictured at the left



04Y-240 BRACKET, SILENCER MOUNT "U"  
Bracket (Quantity 2)  
Pictured at the left



04Y-242 RUBBER, DAMPER (Quantity 4)  
Pictured at the left



04Y-285 GASKET EX. (Quantity 2)  
Pictured at the left



04Y-287 SPRING (Exhaust Spring) (Quantity 4)  
Pictured at the left



04Y-300 MANIFOLD  
EXHAUST RH (V)  
(Quantity 1)  
Pictured at the left



04Y-302 MANIFOLD  
EXHAUST LH (V)  
(Quantity 1)  
Pictured at the left



04Y-306 MAIN  
MUFFLER (V) (Quantity  
1)  
Pictured at the left



04Y-308 TAIL PIPE ELBOW(V) (Quantity 1)  
Pictured at the left



04Y-353 TRIDON (HOSE CLAMP - stainless steel) (Quantity 2) Pictured at the left



04Y-368 BOLT M6-30 (Quantity 2)  
Pictured at the left



04Y-369 BOLT M6-35  
Pictured at the left



04Y-378 BOLT M6-15  
Pictured at the left





04Y-369 BOLT M6-35

04Y-368 BOLT M6-30

04Y-378 BOLT M6-15



04Y-401 M6 NUT

Pictured at the left



04Y-402 SELF LOCKING NUT M8 (Exhaust manifold nut)

Pictured at the left



04Y-406 SPRING WASHER (split lock washer)

Pictured at the left



04Y-421 RUBBER,DAMPER

Note: 4 fender washers, 2 spacers, and 4 rubber grommets are included with this part number.

Pictured at the left

### Installation Instructions for the Type 5 Exhaust system

#### Step 1

Go through all the parts as listed and shown above to make sure that all parts are available and nothing is missing.

#### Step 2

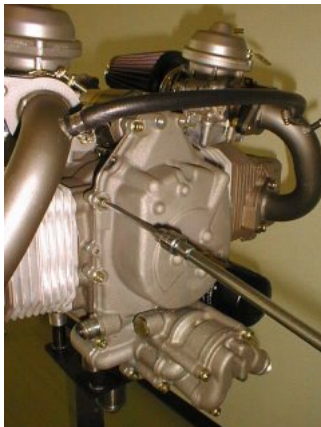

Remove 2 M6 bolts from the back of the engine as shown in the picture at the left. Note: These bolts, after they are removed will not be used again. These bolts will be replaced in the next step with the BOLT M6-30 04Y-368 provided with the the Type 5 Exhaust kit.

#### Step 3



Install the STAY, SILENCER MOUNT "L" bracket (04Y-238) with the COLLAR, SILENCER MOUNT spacer (04Y-239) and the BOLT M6-30 (04Y-368) as shown in the picture at the left.

Step 4



Install two of the four RUBBER, DAMPER (04Y-242) to the PLATE A SILENCER MOUNT (04Y-236) with two of the ten SPRING WASHER split lock washer (04Y-406) and two of the ten M6 NUT (04Y-401) as shown in the picture at the left.

Step 5



Install the remaining two RUBBER, DAMPER (04Y-242) with two of the ten SPRING WASHER split lock washer (04Y-406) and two of the ten M6 NUT (04Y-401) to the STAY, SILENCER MOUNT "L" bracket (04Y-238) installed in Step 3.

Step 6



Attach PLATE A SILENCER MOUNT (04Y-236) prepared at Step 4. The attachment will require two of the ten SPRING WASHER split lock washer (04Y-406) and two of the ten M6 NUT (04Y-401).



Step 7



Install PLATE B SILENCER MOUNT (04Y-237) to top the two RUBBER,DAMPER (04Y-242) that are on top of PLATE A SILENCER MOUNT (04Y-236) installed in the previous step. Attach the vertical back side of PLATE B SILENCER MOUNT (04Y-237) to the engine using two CAP BOLT M6-15 (04Y-378) to the crank case cover as shown at the left.

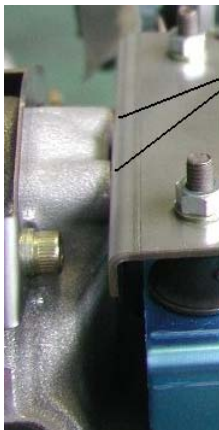

Attach PLATE B SILENCER MOUNT (04Y-237) here using two CAP BOLT M6-15 (04Y-378) to the crank case cover.

The screws should fit into existing taped openings in the crank case cover. The attachment will require four of the ten SPRING WASHER split lock washer (04Y-406), two of the ten M6 NUT (04Y-401), and two CAP BOLT M6-15 (04Y-378).

Step 8

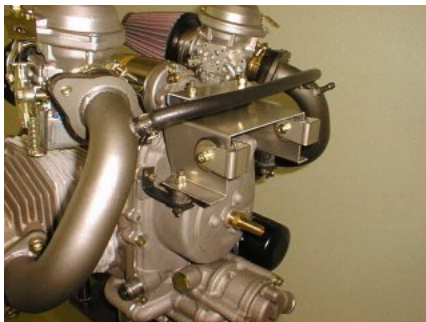

Install the RUBBER DAMPER (04Y-421) and the BRACKET,SILENCER MOUNT "U" Bracket (04Y-240) with BOLT M6-35 (04Y-369) and two of the ten SPRING WASHER split lock washer (04Y-406) and two of the ten M6 NUT (04Y-401).

Step 9

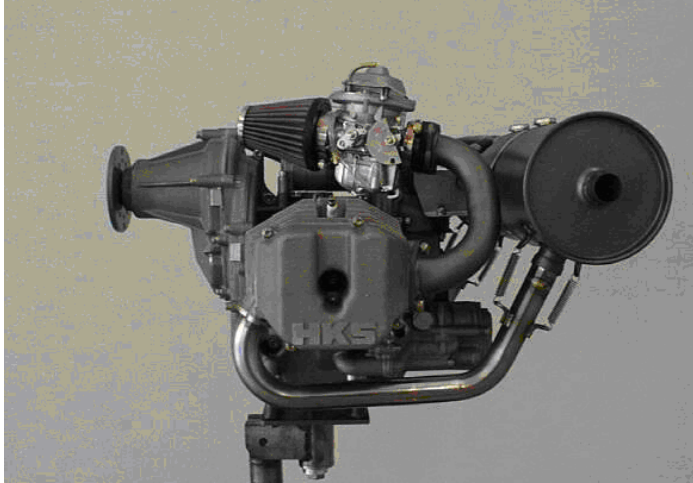

Install MANIFOLD,EXHAUST RH (V) (04Y-300) and MANIFOLD,EXHAUST LH (V) (04Y-302) with the four SELF LOCK NUT M8 (manifold nut) (04Y-402) and two GASKET EXHAUST (04Y-285). Install the MAIN MUFFLER (V) (04Y-306) on the manifold pipes and use the TRIDON (M) HOSE CLAMP - Stainless steel (04Y-353) to secure the exhaust to the BRACKET,SILENCER MOUNT "U" Bracket (04Y-240) installed in step 7 using the two TRIDON (M) HOSE CLAMP - Stainless steel (04Y-353). Tighten the hose clamps securely to hold the muffler firmly in place. Connect the muffler the manifold pipes using the four SPRING Exhaust Spring (04Y-287). Connect the tail pipe to the muffler to direct exhaust gases down and away from the engine.

Cross Reference of Part Numbers for all HKS Exhaust Systems

Description	P/N	Type 1	Type 2	Type 4	Type 5	Type 6
MAIN MUFFLER (VI)	053-003					1
PIPE, EXHAUST-TYPE6 RH	053-002					1
PIPE, EXHAUST-TYPE6 LH	053-001					1
PIPE, EXHAUST-TYPE4 RH	04Y-475			1		
PIPE, EXHAUST-TYPE4 LH	04Y-474			1		
MANIFOLD, EXHAUST-TYPE4	04Y-473			2		2
RUBBER, DAMPER	04Y-421				2	
SELF LOCK NUT M8	04Y-402	4	4	4	4	4
NUT	04Y-401				10	
CAP BOLT M6-15	04Y-378				2	
BOLT M6-35	04Y-369				2	
BOLT M6-30	04Y-368				2	
TRIDON (M)	04Y-353				2	
TAIL PIPE ELBOW(V)	04Y-308			1	1	
MAIN MUFFLER (V)	04Y-306	0		1	1	
MAIN MUFFLER (S)	04Y-305	1	1			
JUNCTION (STD)	04Y-303	1	1			
MANIFOLD, EXHAUST LH (V)	04Y-302				1	
MANIFOLD, EXHAUST RH (V)	04Y-300				1	
MANIFOLD, EXHAUST LH (R)	04Y-298		1			
MANIFOLD, EXHAUST RH (R)	04Y-296		1			
MANIFOLD, EXHAUST LH (S)	04Y-294	1				
MANIFOLD, EXHAUST RH (S)	04Y-292	1				
SPRING	04Y-287	4	4	8	4	8
GASKET EX.	04Y-285	2	2	2	2	2
RUBBER, DAMPER	04Y-242				4	
BRACKET, SILENCER MOUNT	04Y-240				2	
COLLAR, SILENCER MOUNT	04Y-239				2	
STAY, SILENCER MOUNT	04Y-238				2	
PLATE B, SILENCER MOUNT	04Y-237				1	
PLATE A, SILENCER MOUNT	04Y-236				1	
SPRING WASHER	04Y-406				10	

Please note: the Type 5 Muffler set will not fit an engine with horizontal intake manifolds. The carburetors will interfere with the position of the muffler at the back of the engine.